

## F SERIES HELICAL GEAR REDUCER



The F Series is an outstanding solution for customers, looking for a drive that can maximize mounting flexibility. Thank's to the housing's lateral holes, the F Series can also be side mounted directly into the machine, in addition to all the conventional mounting positions. This gear motor guarantees elevated efficiency, reliability and low noise operation. High torque density, a range of wide gear ratios and a compact design complete the F Series characteristics.

Unit Size : 27~157

Input Power : Up to 200 KW

Output Torque : up to 22500 N.m

Gear Ratio : up to 22323:1

## FEATURES

1. Modular design, compact structure. Extra slim parallel shaft helical gear motors are the perfect solution when space is limited.
2. F series gear motors are typically used in conveyor and materials processing applications.
3. Multi stage (2 or 3 stages) gear units for low output speed
4. Hollow output shaft with keyed connection, shrink disk, splined hollow shaft or torque arm.
5. Optional mounting options (foot mounted, flange-mounted, shaft-mounted.)
6. Long life : under the condition of correct type chosen normal operation and maintenance, the life of main parts of speed reducer should not be less than 20000 hrs.
7. Low noise : because main parts of speed reducer are processed, assembled and tested critically, therefore the noise of speed reducer is low.
8. High efficiency (greater than 95%) and high strength

## APPLICATION

Conveyor application  
Chain Conveyor  
Process applications  
Presses  
Extrudes  
Screw conveyors  
Gantry cranes  
Elevator

## FF27~FF107

## HELICAL GEAR DIMENSION DETAIL

## FAF27~FAF107

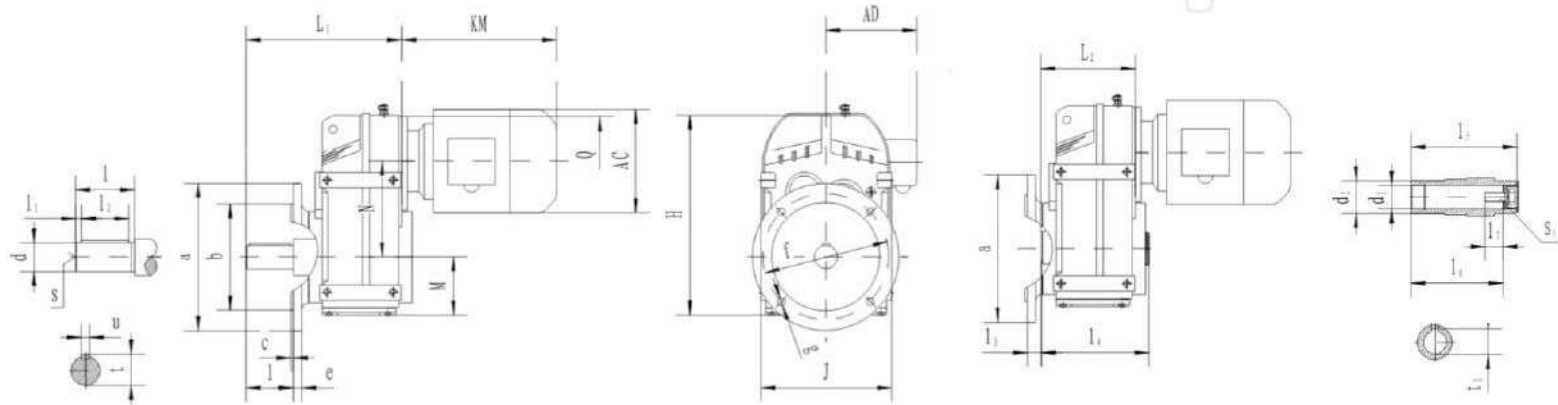

Model	a	c	f	Shaft dimension				Hollow shaft dimension					H	L <sub>1</sub>	M						
				b	e	g	d	l <sub>1</sub>	s	t	d <sub>1</sub>	l <sub>1</sub>				l <sub>2</sub>	l <sub>3</sub>	t <sub>1</sub>	J	L <sub>2</sub>	N
FF 27.. FAF27..	160 110j6	3.5 10	130 8.5	25k6 50	5 40	M10	28 8	25H7 40	20 107	104 89	17 M10X25	28.3 8	223 150	165 118.5	60 98.7 120						
FF 37.. FAF37..	160 110j6	3.5 10	130 9	25k6 50	5 40	M10	28 8	30H7 45	24 123	120 105	17 M10X25	33.3 8	252 165	184 138	76 112 120						
FF 47.. FAF47..	200 130j6	3.5 12	165 11	30k6 60	3.5 50	M10	33 8	35H7 50	25 153	150 132	22 M10X25	38.3 10	269 180	218 162	77 128.1 120						
FF 57.. FAF57..	250 180j6	4 15	215 13.5	35k6 70	7 56	M12	38 10	40H7 55	23.5 170	166 142	29 M16X40	43.3 12	317 200	243 177	93 136 160						
FF 67.. FAF67..	250 180j6	4 15	215 13.5	40k6 80	5 70	M16	43 12	40H7 55	23 184	180 156	29 M16X40	43.3 12	343 212	264 188	97 159.5 160						
FF 77.. FAF77..	300 230h6	4 16	265 13.5	50k6 100	10 80	M16	53.5 14	50H7 70	37 213	210 183	32 M16X45	53.8 14	426 270	330 234	121 200 200						
FF 87.. FAF87..	350 250h6	5 18	300 17.5	60m6 120	5 110	M20	64 18	60H7 85	30 243	240 210	36 M20X50	64.4 18	531 330	374 259	152 246.7 250						
FF 97.. FAF97..	450 350h6	5 22	400 17.5	70m6 140	7.5 125	M20	74.5 20	70H7 95	41.5 303	300 270	34 M20X50	74.9 20	623 400	456 321	178 285 300						
FF 107.. FAF107..	450 350h6	5 22	400 17.5	90m6 170	5 160	M24	95 25	90H7 118	41 353	350 313	40 M24X60	95.4 25	717 450	523 358	200 332.4 350						